

ACOUSTISERIES

4H Fire-Rated Acoustic STC55 Steel Doors

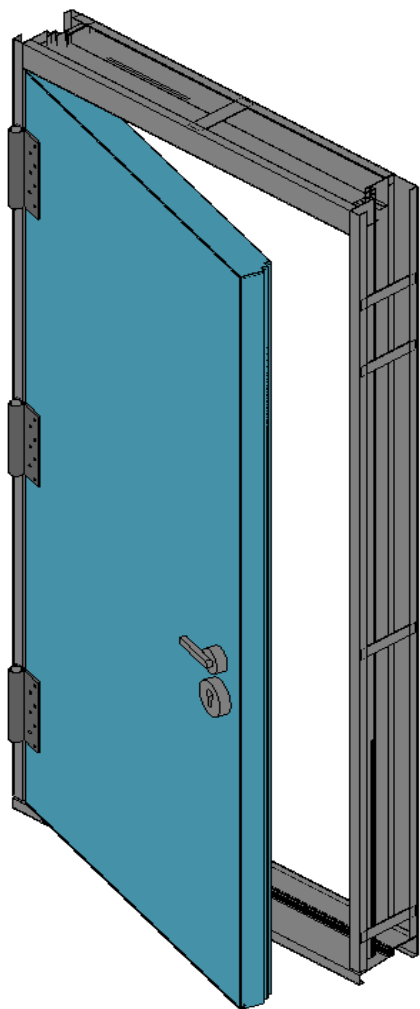

Fire Rating: Up to 4 hours, under BS 476:Part 22:1987; ISO 3008; EN 1634; SS 332:2007

Acoustic Rating: STC 30 to 55, under ASTM E-90; ASTM E413; ISO 140

Doorleaf: 47 to 90 mm thick door leaves formed from 1.5 - 2.0 mm electro-galvanized (zinc-coated) or stainless steel skins, constructed with proprietary sound-attenuating concealed drop seal inside bottom edge.

Frame: 1.5 mm electro-galvanized (zinc-coated) steel, welded and ground smooth, complete with mortar boxes. 3 or 4-sided frame is supplied with a proprietary uninterrupted seal arrangement.

Finish: Primer coat only unless otherwise specified.

Hardware: Proprietary 3 heavy duty hinges, one door-closer, and a mortise lockset. May require proprietary TACAM™ seal compression roller handle or Cremone lock.

Weight: 35 ~ 70 kg/m².

Max. Sizes: *Single Leaf* 1,300 x 2,400 mm
Double Leaf 2,400 x 2,400 mm

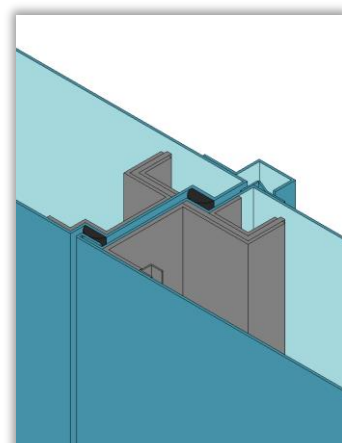
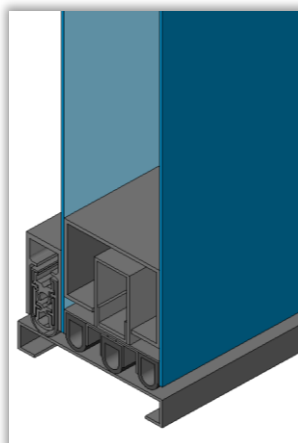
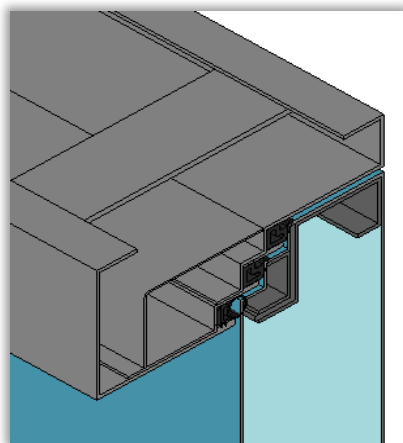
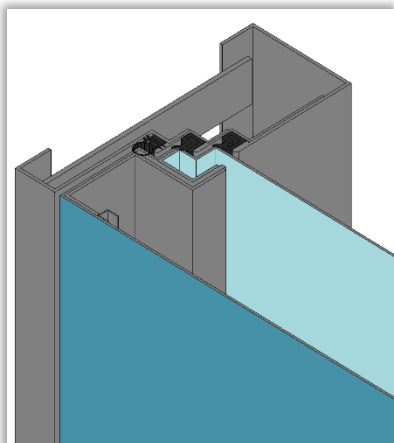

ACOUSTISERIES

4H Fire-Rated Acoustic STC55 Steel Doors

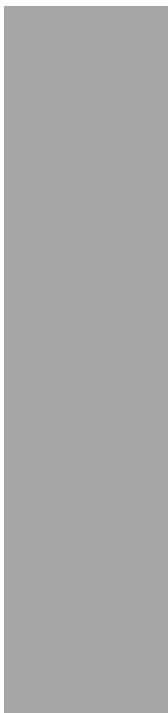
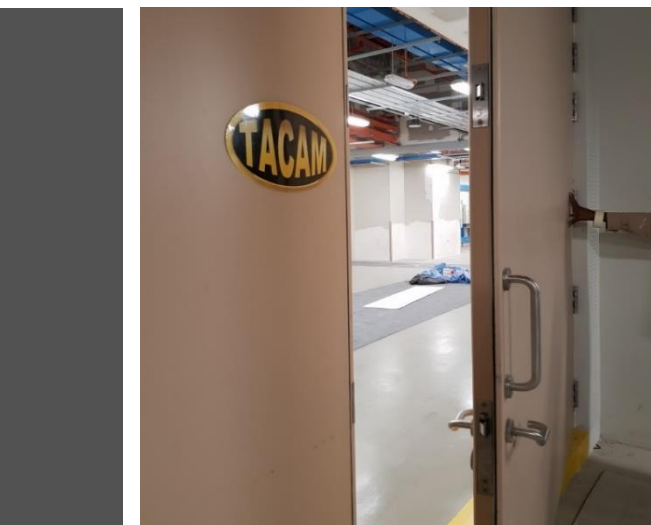
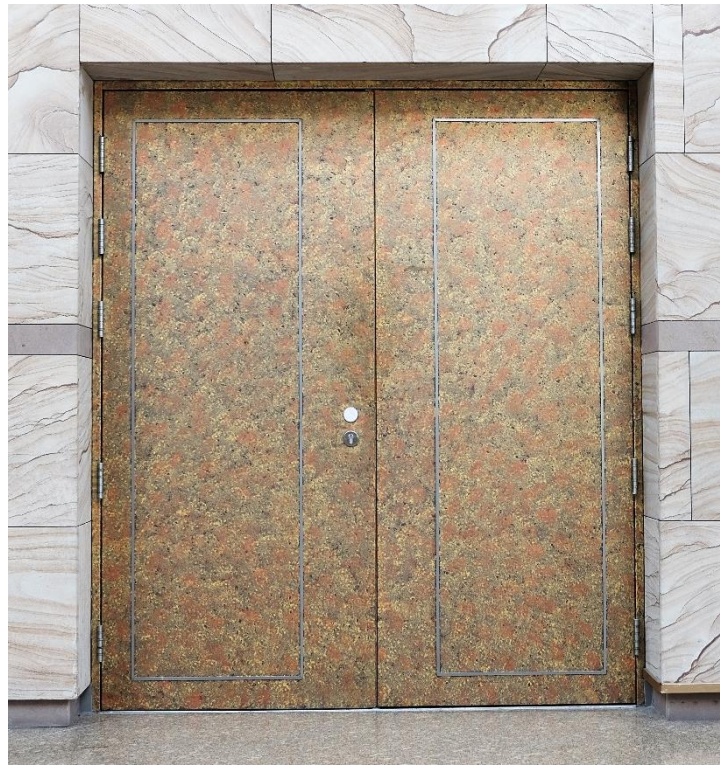

TACAM STEEL PTE LTD